

Rotor Thickness Centered in Coil Assembly

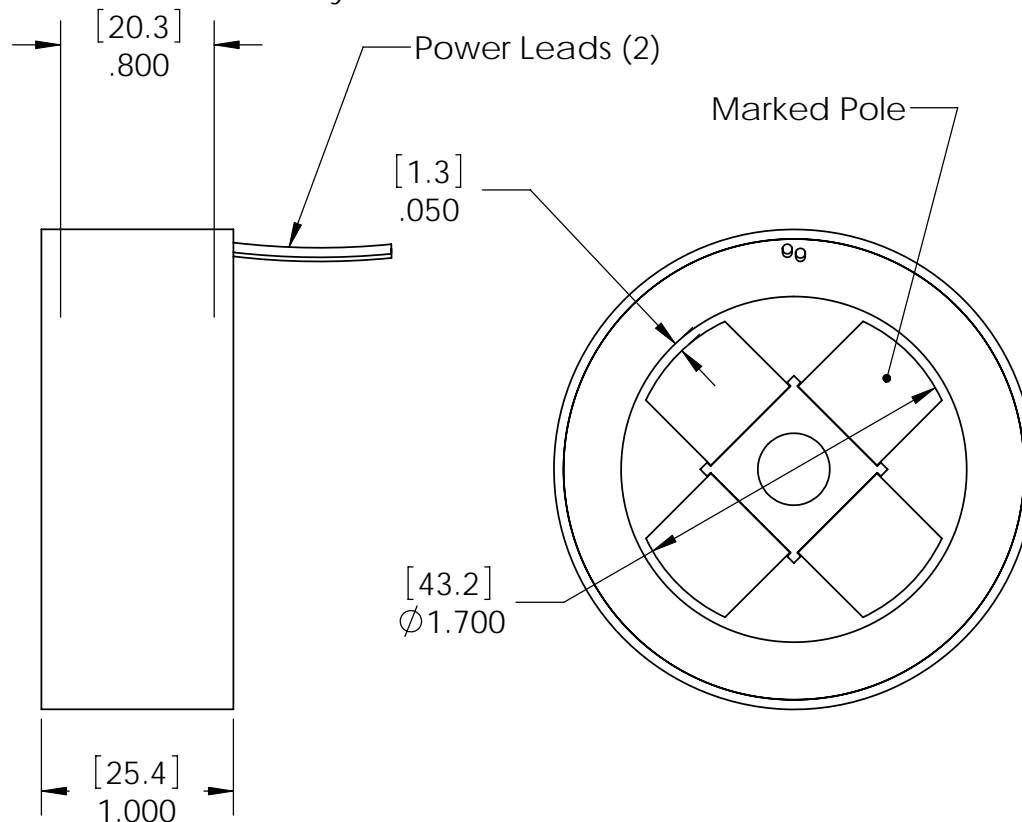

Notes:

1. Torquer is shown at the middle of the continuous torque range.
2. When + is connected to Red, and - is connected to Black, then the rotor as shown in the right hand view, will turn clockwise.
3. The torquer is a kit style torque motor, and does not have integrated bearings.

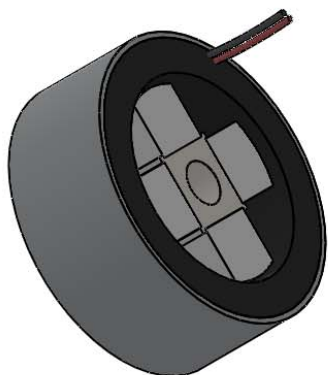

UNLESS SPECIFIED OTHERWISE:
All dimensions are in inches
Standard Tolerances are as follows:
.XXX $\pm .005$ ANGLES $\pm 1^\circ$
XX $\pm .010$ FILLETS $.010$
X $\pm .020$ CORNERS $.010$
Remove All Burrs and Sharp Edges

MATERIAL

FINISH

DRAWN	DATE	APPROVED	DATE
JRM	09-10-10	MPW	09-10-10

TITLE

H2W Technologies, Inc.
26470 Ruether Ave. #102 Santa Clarita, CA 91350 USA
Tel: (661)251-2081 Fax: (661)251-2067
www.h2wtech.com

**Limited Angle Torque Motor
Model # TMR-040-25-025-4**

DWG #	REV	SHEET
80-0238	A	1 of 2

LIMITED ANGLE TORQUE MOTOR SPECIFICATIONS		
Motor P/N	TMR-040-25-025-4	
Continuous Torque Range	40 degrees	0.70 Radians
Radial Clearance	0.050" per side	1.27 mm per side
Bearing Type	None Provided	
Moving Mass	0.33 lbs	150 grams
Total Mass	0.77 lbs	350 grams
Resistance @ 20C	6.0 ohms	
Inductance @ 20C	2.3 mH	
Electrical Time Constant	0.38 msec	
Motor Constant	5.2 in-oz/SQRT(Watt)	0.04 N-m/SQRT(Watt)
Torque Constant	13 in-oz/Amp	0.09 N-m/Amp
Back EMF	0.09 Volts/rad/sec	
Continuous Torque	19.5 in-oz	0.14 N-m
Max Power @ 100% Duty	14 Watts	
Peak Torque	58.5 in-oz	0.41 N-m
Max Power @ 10% Duty	125 Watts	
Rotor Inertia	6.12 oz-sq.in.	1.12 E-4 kg-sq.m